

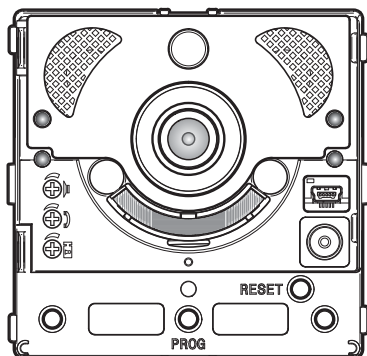

## Communication unit for Xip systems

FA01403-EN

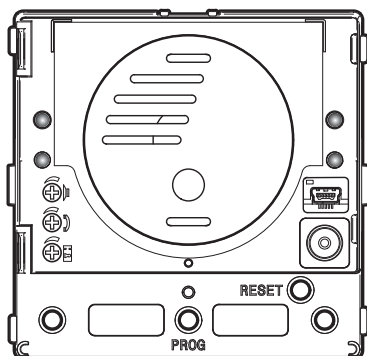

**MTMA/08 - MTMV/08**



PROGRAMMING MANUAL



## General precautions

- **⚠ IMPORTANT!** Important safety instructions: **READ CAREFULLY!**
- Installation, programming, commissioning and maintenance must only be carried out by expert qualified technicians in full compliance with the regulations in force.
- Wear anti-static shoes and clothing if working on the electronic circuit board.
- Keep this precaution information.
- Disconnect the power supply during any cleaning or maintenance work.
- The product must only be used for the purpose for which it was expressly designed. Any other use is to be considered dangerous.
- The manufacturer declines all liability for any damage as a result of improper, incorrect or unreasonable use.
- This device complies with Part 15 of the FCC Rules. Operation is subject to the following two conditions:
  - 1 - This device may not cause harmful interference.
  - 2 - This device must accept any interference received, including interference that may cause undesired operation.

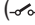
## OPERATIONS FOR REMOTE CONTROL OF CALL BUTTONS

### Manual configuration of terminals and as call inputs 1 and 2

Short circuit the terminals ( and ) , press and hold the two call buttons on the unit, and power the device. The unit restarts. The procedure has been completed successfully.

Remove the short circuit and connect the additional N.O. buttons to the terminals  and .

## BUTTON NUMBERING

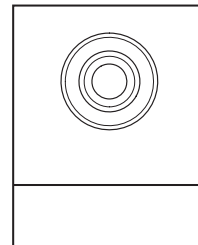
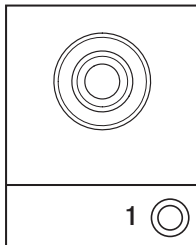
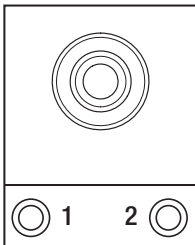
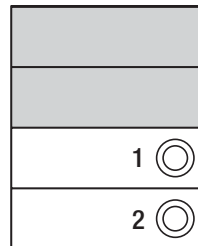
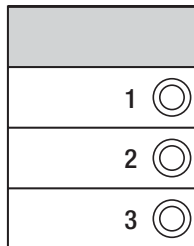
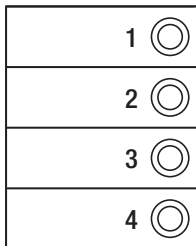
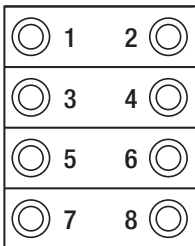

## Entering programming mode

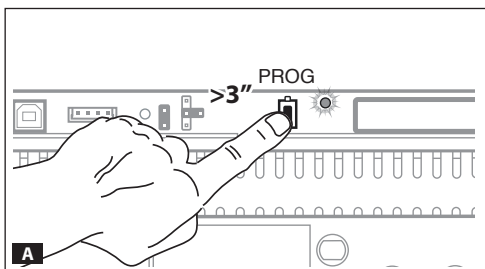

Press the PROG button on the power supply **A** until the PROG LED lights up.

The LEDs and and the button LEDs flash to show the buttons are being programmed **B**.

## Programming buttons

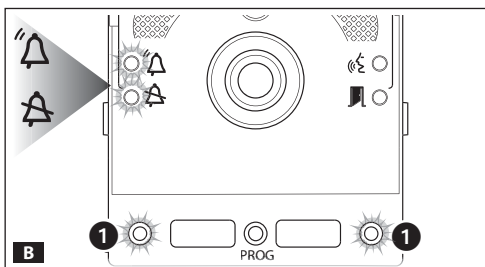

Press the first call button on each unit **C D** (see “Button numbering” section) until the blue LED and the button LEDs stop flashing.

**i** The LED lights on the unit remain on to show that the buttons have been programmed correctly.

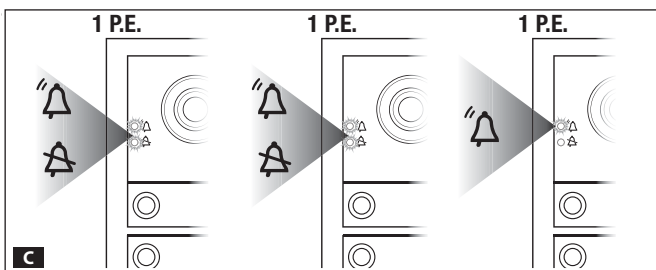

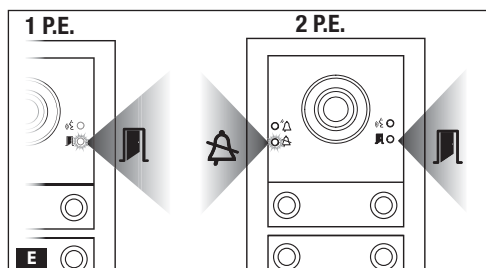
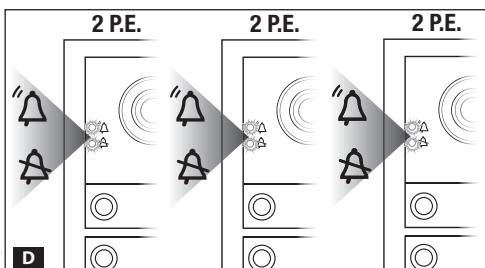

**i** For the basic unit (no call buttons), you do not need to press the buttons that are shown as flashing in figure **B** **1**.

Repeat for all entry panels to be programmed. Once programming is complete, the configuration is implemented **E** and you are automatically taken to “programming calls”.

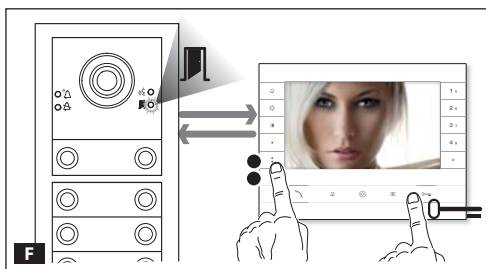

## Programming calls

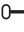

The green LED  flashes. Lift the internal receiver handset (if present) and press the door lock release  and AUX2  buttons **F**.

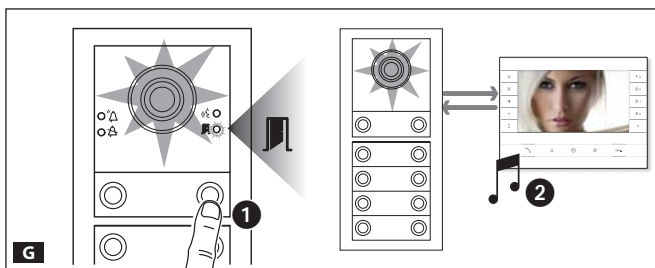

On the entry panel, press the call button to be linked to the internal receiver **G** **1**. A beep confirms that the setting has been stored **G** **2**. End the call and repeat for the other internal receivers.

**i** The operation can only be carried out from the entry panel with the blue LED  off (1 entry panel in **F**). To change the entry panel from which calls are programmed, press one of the call buttons on the entry panel you wish to use for programming.

**i** You can force the switch from one programming mode to another by pressing the PROG button on the power supply unit for 3 seconds and releasing within 6 seconds. If you force the switch to call programming from button programming, the button units which have not been programmed are configured to 8 calls. If the base unit is not programmed, calls are not configured.

## Exiting Programming

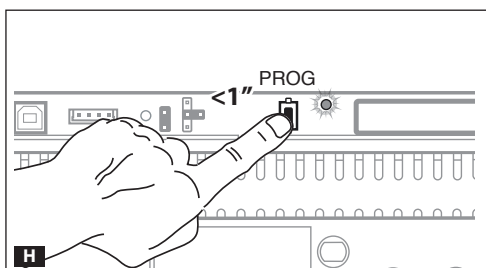

Press the PROG button briefly **H**. The LEDs on the entry panel switch off.

## Adjusting the brightness and colour of the unit backlight

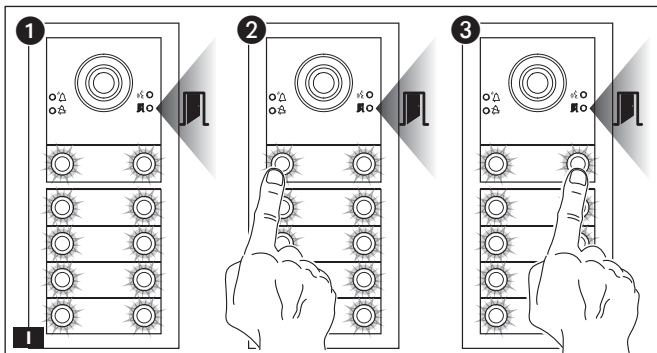

During call programming **I 1**, you can control the brightness and colour of the unit backlight. Press the left call button to select white **I 2**, and the right call button to select blue **I 3**.

Press the same button repeatedly to select one of the five brightness levels (off, 25%, 50%, 75%, 100%).

## Programming the entry panel video camera

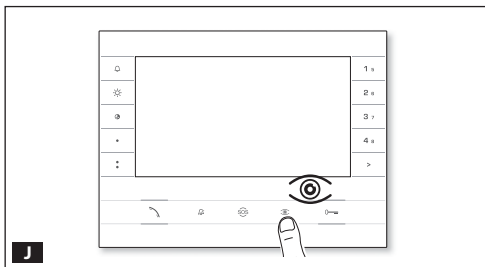

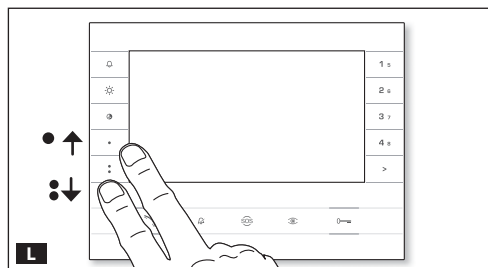
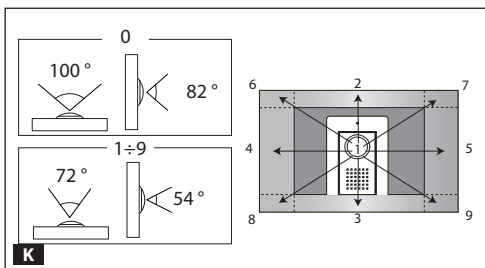

While programming the calls, the “visual range” of the video camera can be adjusted from any receiver. To do this, lift the handset (where present) and press the “self-connection” **J**.

Starting from the default configuration, scroll through the subsequent configurations **K** by pressing the AUX1 **•** button, or go back to the previous configurations by pressing the AUX2 **•** button **L**. Settings are saved automatically.

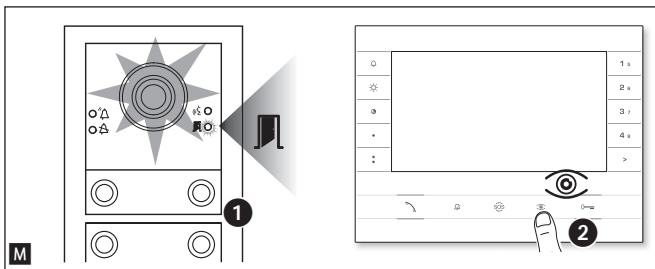

## Adjusting the brightness level of the light on the entry panel



While programming calls **M 1** the brightness level of the entry panel can be adjusted from any receiver. Pressing the “self-connection ” button on the internal receiver **M 2** activates the video camera on the entry panel for which the brightness level is to be adjusted.

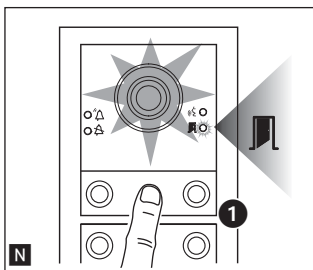



Use a previously assigned call button to increase/decrease brightness of the light **N**.

## Reprogramming

Reprogramming a system which has already been programmed, you access the call programming phase directly. To access button reprogramming, follow the process for forcing the mode switch described above (Page 4).

If you add, replace or remove an entry panel, you must follow the “programming buttons” procedure so that the system recognises the changes.

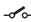
## RESTORE FACTORY DEFAULT

To restore the entry panel to the default settings (including the terminal functions , ) , remove the power supply, press and hold the two call buttons on the unit and power the device.

After 5 seconds the entry panel restarts.

 If the entry panel does not restart, it has not been restored to default settings.

This product complies with the relevant directives in force.

**Decommissioning and disposal.** Dispose of the packaging material and the device at the end of its life cycle responsibly, in compliance with the laws in force in the country where the product is used. The recyclable components are marked with a symbol and the material's ID marker.

THE DATA AND INFORMATION SHOWN IN THIS MANUAL ARE TO BE CONSIDERED AS SUBJECT TO CHANGE AT ANY TIME AND WITHOUT THE NEED FOR ANY ADVANCE WARNING.

MEASUREMENTS, UNLESS OTHERWISE INDICATED, ARE IN MILLIMETRES.

**CAME**   
**BPT**

[CAME.COM](http://CAME.COM)

**CAME S.P.A.**

Via Martiri Della Libertà, 15  
31030 Dosson di Casier - Treviso - Italy  
tel. (+39) 0422 4940 - fax. (+39) 0422 4941